

STATION ROAD

SETTING AND ACCESS

Railway Walk and the Circular Walk

The site marks the junction between the Circular and Railway walks, currently there are no rights of way across the site.

A key part of the landscape proposals are the repairing of the historic railway platform and cleaning and re-draining of the track-bed.

By reorganising the carpark and pathways we are able to define the existing path and provide a separate route for walkers to use.

This will also involve connecting the route to the pavement outside the Chandos Road buildings and the construction of a new crossing, subject to highways approval.

The University would like to secure access for local residents to these important amenity routes and these proposals will finally formalise the pathways across the site securing their use for years to come.

Ecology

The proposals involve the removal of the existing self set trees adjacent to the East side of the carpark

As part of the development we will re-landscape the external spaces around the building, including the planting of new trees.

Details of the trees to be removed and the protection proposals for the retained trees during construction will be detailed in the Arboricultural Report submitted as part of the planning application.

An Ecology report has also been prepared which shows no evidence of protected species or plants within the development area. This report will also be submitted with the planning application.

All new plant species chosen will be suitable for the sensitive locality.

Transport

The proposed carpark has 57 spaces, 6 more spaces than the existing, it will also have dedicated disabled bays and motorcycle parking. In addition there will be 28 cycle spaces.

A full transport report and parking survey has been conducted and will be submitted as part of the application.

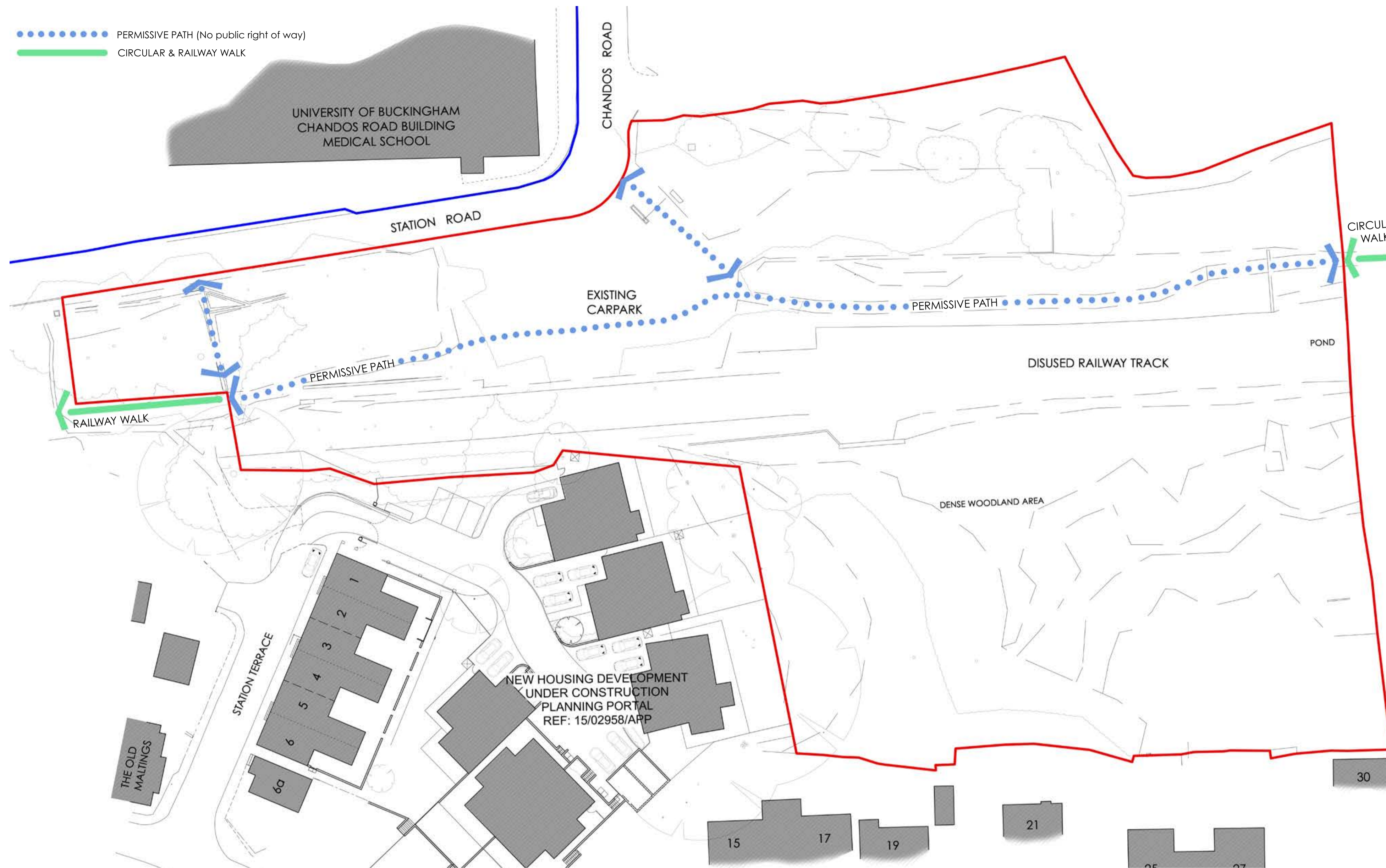

Existing site access routes - showing the permissive path through the site. The redline shows land owned by the University



Circular Walk



Approach to carpark from Railway Walk



Railway Walk approaching start of former platform

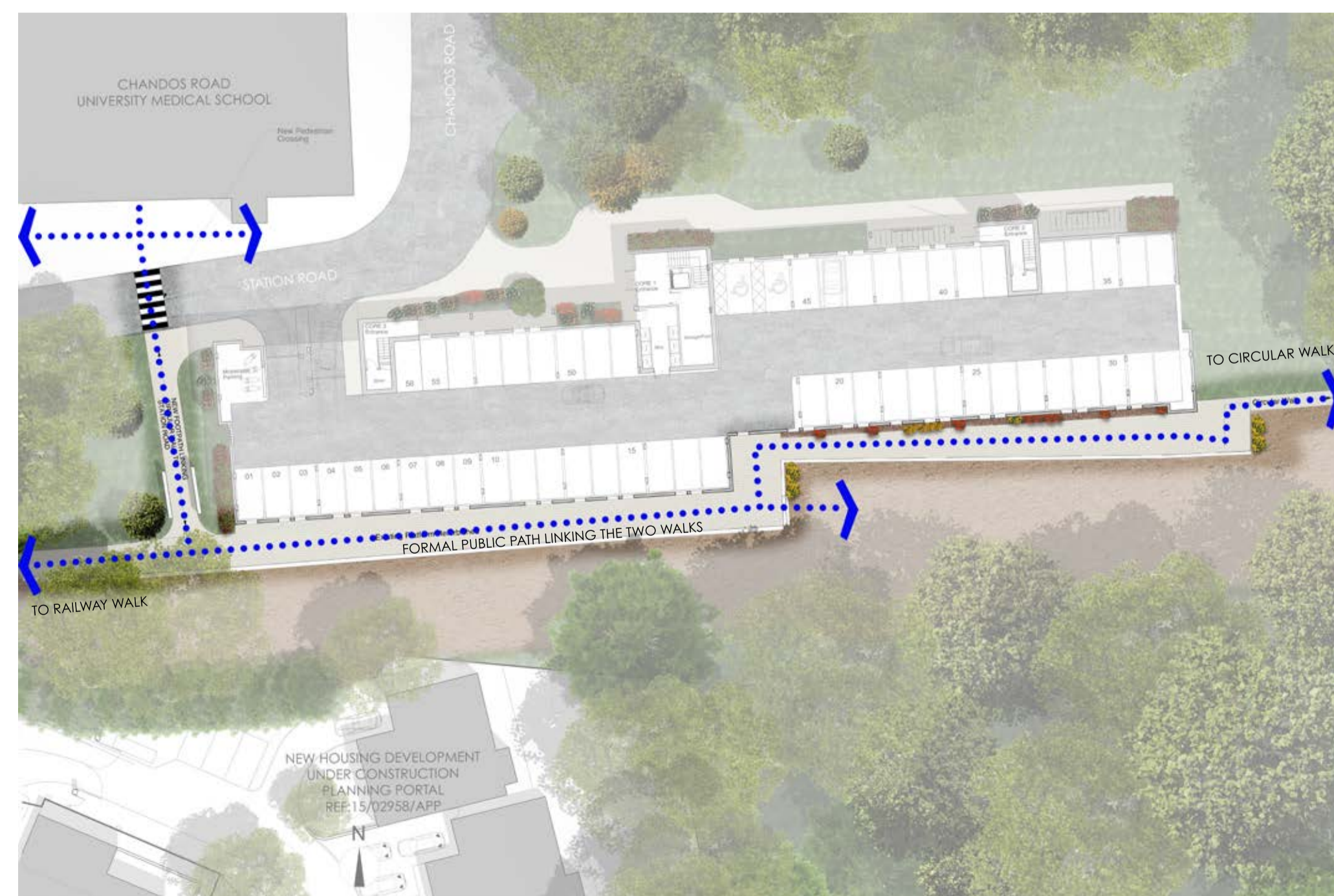

Proposed Site Access routes - Refurbished Railway platform connects the Buckingham Circular Walk with the Railway Walk.

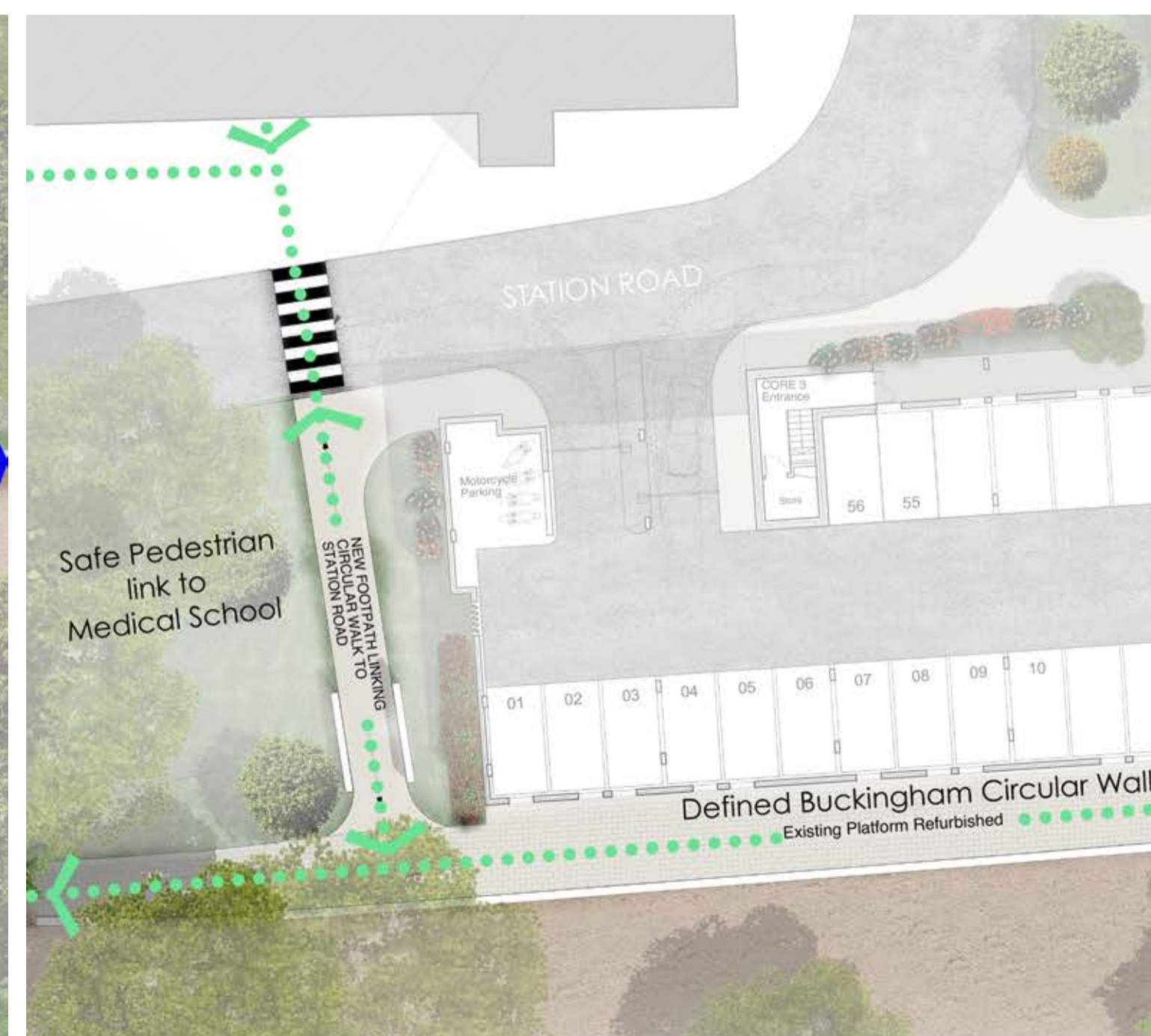

West end of site: New, Safer access point linking Station Road, the Buckingham Circular Walk and the Railway Walk

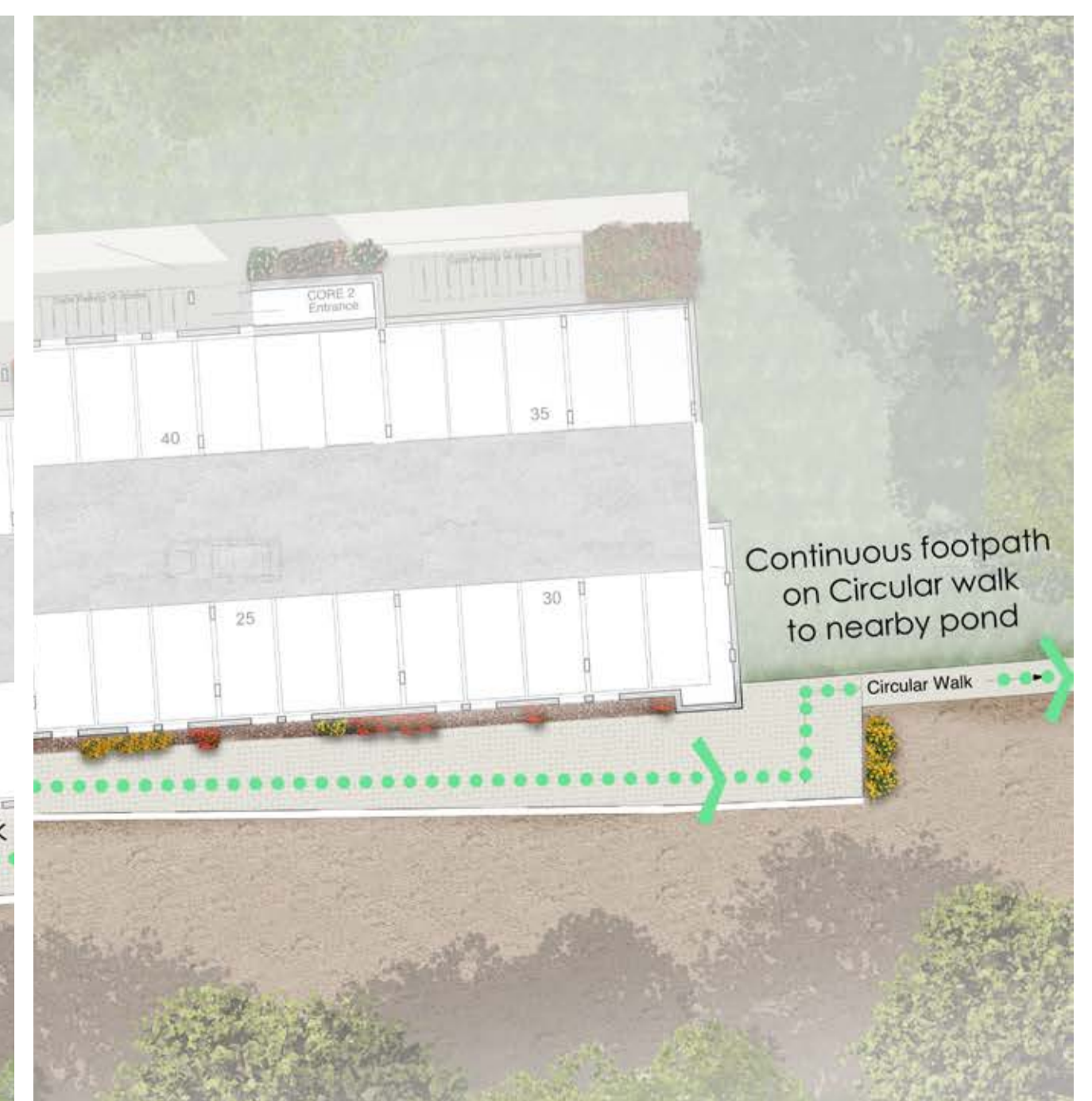

East End of Site: Circular Walk defined and connected along restored station platform.